

Name: **Junction box**

Ceiling junction box for 13/26 mm board

System Ideal

Type: AU70

EAN: 6418677332357

Description: The ceiling junction box has two screw pillars for M4 screws, e.g. for attaching lamp connectors or roof lids and screw distance is c/c 70 mm. The green adapter ring, delivered with the box, is used when board thickness is 12-13 mm. The ring is removed when the board thickness is 24-26 mm e.g. double plaster board. There are 8 fixed inlets for 20 mm conduits, and 6 have an adapter for 16 mm conduit. All inlets are equipped with a locking device in metal for reliable connection between the conduits (flexi or stiff pipe) and the box. In addition, there are two knock outs in the bottom for different inlets. Manufactured from halogen free material (IEC/61249-2-21), the box complies with the IEC/EN60670:2005 glow wire test (850 °C).

Package: 50

Unit: PCS

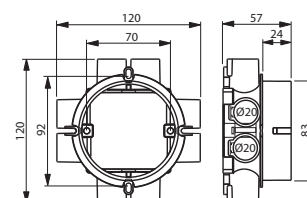

Technical specification

Dimensions

For plastic pipe Ø16/20mm

Electrical quantities

Rated voltage 400 V

thermal conditions

Operating temperature -25 ... 90 °C

ETIM

ETIM 5.0 EC002601 (EC002601)

ETIM 6.0 EC002601 (EC002601)

ETIM 6

Mounting method Flush mounted (plaster)

Shape Round

Construction type Cable junction box

Model Single

Provided with revolving ring

Can be coupled

Equipped with None

Diameter 92 mm



PRODUCT CARD

1.11.2017

AU70

2/2

Depth	57 mm
Internal depth	53 mm
For number of electric fittings	1
Mounting switching equipment	Screwing
With screws	
Housing feed-through by break-out opening	
Housing feed-through by seal membrane	
Housing feed-through by nozzle	1
Housing feed-through by step membrane	
For tubediameter	Other
Pipe locking	1
Pipe locking optional	
Inlet from the rear	1
Number of inlets	8
Number of included spouts	8
Material	Plastic
Halogen free	1
Surface protection	Untreated
Colour	Blue
Degree of protection (IP)	Other
Cover	Not transparent
Cover attachment	Snapped on
Sealable	
Circuit integrity	None
With screening	
Wind proof	
Max. conductor cross section	0 mm ²
Number of poles of the clamp	
Clamp position fixed	
Luminaire hook mounting	
Nozzle	None
With nail lugs	1

Address
P.O. Box 16
06101 Porvoo
FINLAND

ABB Exchange
+358 10 22 11

Customer service
kotimaanmyynti@fi.abb.com

Web
<http://www.abb.fi>

Business ID
0763403-0