

PRODUCT UPDATE

Split phase connection for CE product quick guide

Split phase connection requires to be first enabled via the Terra Config app v1.6.1 within [Settings] > [Electrical Grid Network Type].

To connect Split phase network changes to the Input wiring only are required – as shown in the diagrams below, the output remains the same.

Note the option is supported via FW 1.3.5 and TC app 1.6.1, or higher.

Setting Split Phase in the TerraConfig app

Open TerraConfig app, connect to the charger and from the main page menu go to [Settings] -> [Electrical Grid Network Type] -> select [Split Phase]

Step 1

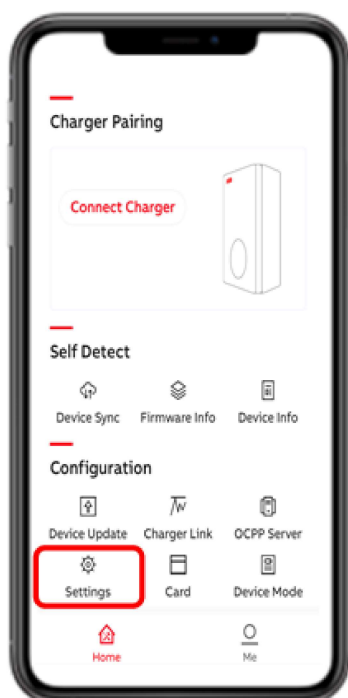

Step 2

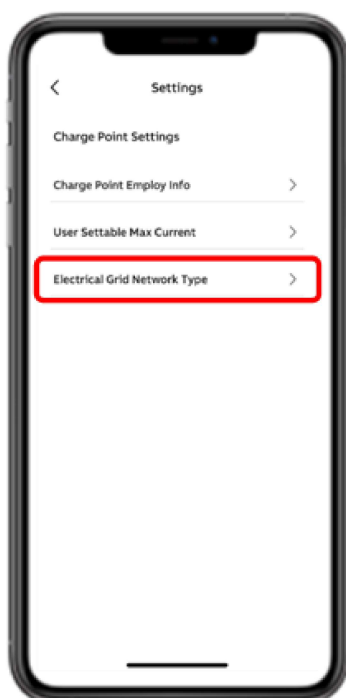

Step 3



Step 4



1. Connection diagram for 3-phase charger

Connect the input wiring according to Figure.1.

The voltage between each phase should be 120 Vac.

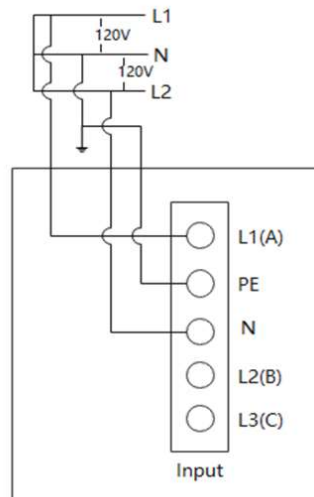

Fig.1

2. Connection diagram for single phase charger

Connect the input wiring according to Figure.2.

The voltage between each phase should be 120 Vac.

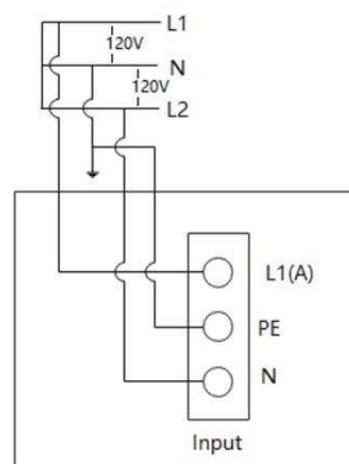

Fig.2