



# RT2008

Einschubwerkzeug für RUNPOGLEITER Spirale MET  
Tool for pull in RUNPOGLIDER spiral MET



## Gebrauchsanleitung | Instruction Manual

**DE** Gebrauchsanleitung  
**EN** Instruction Manual  
**FR** Notice d'emploi  
**ES** Instrucciones de uso  
**PT** Instruções de utilização  
**IT** Istruzioni per l'uso  
**NL** Gebruiksaanwijzing  
**DK** Betjeningsvejledning

**SE** Bruksanvisning  
**NO** Bruksanvisning  
**FI** Käyttöohje  
**PL** Instrukcja obsługi  
**CZ** Návod pro použití  
**HU** Használati útmutató  
**RU** Инструкция по применению

**LT** Naudojimo instrukcija  
**IS** Notkunarleiðbeiningar  
**SL** Návod na použítie  
**SK** Navodilo za uporabo  
**HR** Upute za uporabu  
**TR** Kullanım Kılavuzu



## PRODUCT FEATURES – PAGE 3

Articles (included in set)		Item no.
1	RUNPOTEC RT 2008 incl. clamping mechanisms	20004
2	Pluggable attachment Ø 40 mm	20040
3	Pluggable attachment Ø 32 mm	20032
4	Pluggable attachment Ø 25 mm	20025
5	Pluggable attachment Ø 20 mm	20020
6	Pluggable attachment flexible socket	20010
7	Pluggable coupling + belt clip – set	20333
8	RUNPOTEC system case with RT 2008 case insert	20611
9	RUNPOGLIDER spiral MET (metal spiral) – 15 m	30018
<b>Accessories (not included in set)</b>		
10	Pluggable attachment socket rigid 90° (also suitable for tube Ø 20 mm)	20253



## SAFETY INFORMATION

The RT 2008 can only be operated with the RUNPOGLIDER spiral MET! Never use the RT 2008 near live wires – the RUNPOGLIDER spiral MET (metal spiral) is electrically conductive! **Caution risk of fatal injury!**



## INTRODUCTION

Thank you for purchasing this **RT2008 – insertion tool for RUNPOGLIDER spiral MET** by RUNPOTEC. These operating instructions describe the safe use of your RT2008. **Read the instructions for use thoroughly before commissioning.** If you have any questions about commissioning, assembly, safety and applications, or problems, please contact your dealer or RUNPOTEC by telephone or e-mail. You will find our contact data on **page 2. Application videos on [www.runpotec.com](http://www.runpotec.com)**

## APPLICATION

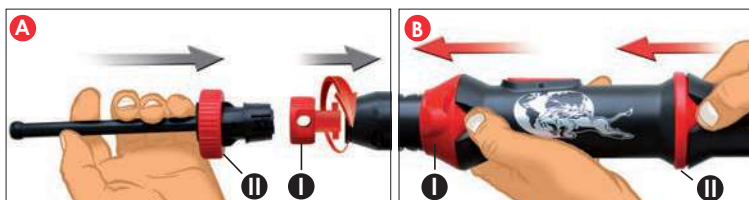

I. Push on and **rotate** the pluggable coupling! **Push on the red locking rings (I and II).**  
II. Fit the flexible socket pluggable attachment.



Thread the RUNPOGLIDER spiral MET (metal spiral) **in or through**. **Push the red locking rings (I and II) to close.**

All images are representative. Changes and printing errors excepted.



Insert the pluggable attachment into the tube end.

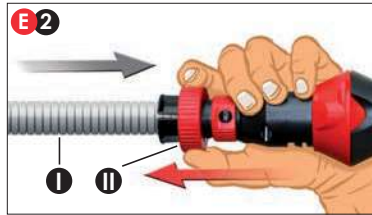

Push in the tube (I) up to the stop and secure with the red clamping ring (II).



Press the pushbutton until it latches (**CLICK!**).

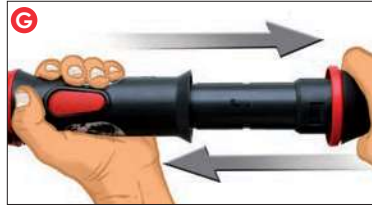

Pump to push in the RUNPOGLIDER spiral MET.

## ROTATION FUNCTION

If you hit an obstacle that cannot be overcome through normal pumping, enable the rotate function, which additionally causes the spiral to rotate, in order to overcome even troublesome, problematic points.

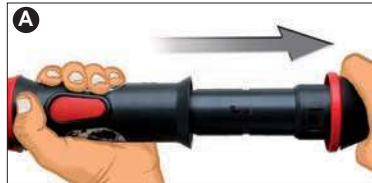

Fully extend the telescopic tube.



Turn the clamping handle clockwise to clamp. The spiral is axially clamped.



Turn and advance the ratchet alternately several times.

## SPECIAL FUNCTION

As of a **pipe length of 20 m** we recommend the additional use of a cordless screwdriver to overcome the problem areas more easily.

Rotate the spiral with the cordless screwdriver **clockwise only**.

- I. Clamping handle open
- II. Keep spiral tensed.
- III. Optimum speed: 800-1200 rpm.

