

# SHUT-OFF ADAPTER

For saddle



## Design features

- Drilling under pressure with the shut-off system that has been tried and tested for decades
- This shut-off adapter can be used for under pressure drilling with every type of standard saddle
- Note: The external thread is one size larger than the internal threaded outlet, except on the 2" size, this to provide greater strength
- Cover shut-offs with internal thread are fitted with a corrosion protection ring to prevent corrosion and incrustation
- All external threads must be protected according to standard occupational procedure

## Material | Technical features

- 1 **Body** made of ductile iron, epoxy powder-coated
  - 2 **Seal cover** made of POM, with rubber seal, fibre glass reinforced
  - 3 **Bolts and washers** made of stainless steel
- **Seal** and **corrosion protection ring** made of elastomer
  - Drilling instructions (see page I 3/1)

## Suitable accessories

**Drilling machine:** No. 5800, No. 5805  
**Saddle blade** No. 8401

## No. 3720



Order No.	MOP (PN)	Internal thread ISO 228	External thread EN 10221-1	Internal thread ISO 228
3720	16	1"	1¼"	
		1"		1"
		1¼"	1¼"	
		1¼"	1½"	
		1½"	2"	
		2"	2"	

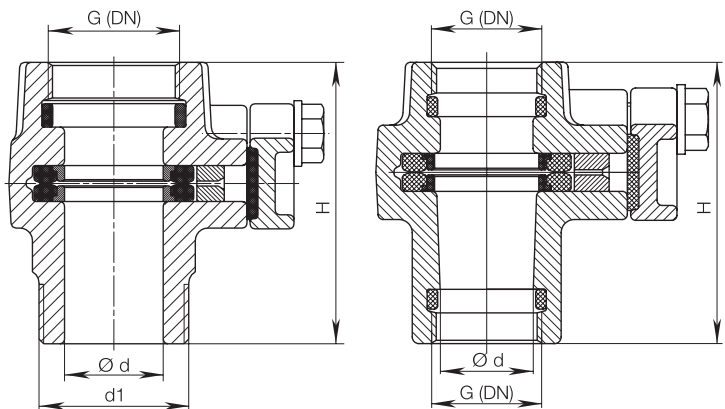

\* Both ends internal thread ISO 228

G (DN) ISO 228	d1 EN 10226-1	H	Ø d	Weight
1"	1¼"	85	27	1,1
1"	1"	85	27	1,1
1¼"	1¼"	90	27	1,4
1¼"	1½"	90	31	1,3
1½"	2"	95	37	1,7
2"	2"	100	42	1,8

## Application examples

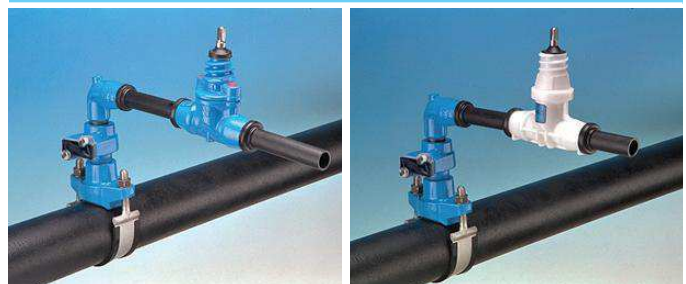

I 5/2



**E. Hawle Armaturenwerke GmbH** 4840 Vöcklabruck - Austria - Wagrain Straße 13  
 Tel.: +43 (0) 7672 72576 0 - Fax.: +43 (0) 7672 78464 - E-Mail: hawle@hawle.at - www.hawle.com