

# Lampholders for Discharge Lamps

## E27 lampholder

Casing: porcelain, white, T210  
Nominal rating: 4/250/5 kV  
Screw terminals: 0.5-2.5 mm<sup>2</sup>  
Spring loaded central contact  
Threaded bushes for screws M3  
Weight: 69.3 g, unit: 200 pcs.  
Type: 62622

**Ref. No.: 108416**

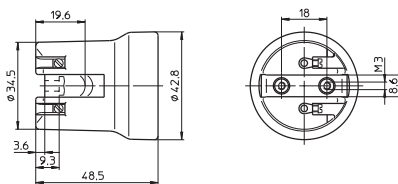

1

2

## E27 lampholders

Casing: porcelain, white, T210  
Nominal rating: 4/250/5 kV  
Screw terminals: 0.5-2.5 mm<sup>2</sup>  
Spring loaded central contact  
Oblong holes for screws M4, length max. 15 mm  
Weight: 106.8/103.9 g, unit: 100 pcs.

Type: 62104

**Ref. No.: 102615**

Type: 62105 with lamp safety catch

**Ref. No.: 102617**

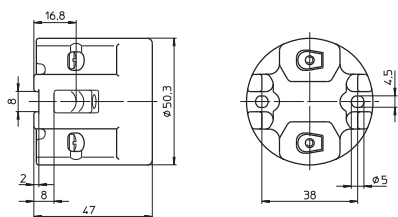

3

4

## E27 lampholders

Casing: porcelain, white, T210  
Nominal rating: 4/250/5 kV  
Screw terminals: 0.5-2.5 mm<sup>2</sup>  
Spring loaded central contact  
Fixing bracket with slot for screws M5  
Weight: 113 g, unit: 100 pcs.  
Type: 62110

**Ref. No.: 106585**

Type: 62111 with lamp safety catch

**Ref. No.: 109568**

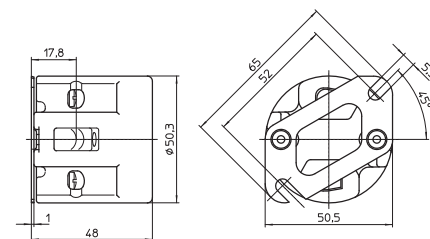

5

6

## E27 lampholders

Casing: porcelain, white, T270  
Nominal rating: 4/250/5 kV  
Screw terminals: 0.5-2.5 mm<sup>2</sup>  
Spring loaded central contact  
Fixing oblong holes for screws M4  
Weight: 60.6 g, unit: 200 pcs.  
Type: 62050

**Ref. No.: 102599**

Type: 62010 with lamp safety catch (with spring)

**Ref. No.: 102577**

Type: 62009 with lamp safety catch (with crushing)

**Ref. No.: 544605**

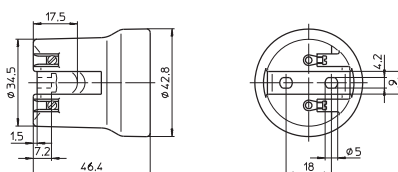

7

8

## E27 lampholder

Casing: porcelain, white, T270  
Nominal rating: 4/250/5 kV  
Screw terminals: 0.5-2.5 mm<sup>2</sup>  
Spring loaded central contact  
Fastening bushes for screws M3  
Weight: 66.3 g, unit: 200 pcs.  
Type: 62015

**Ref. No.: 102582**

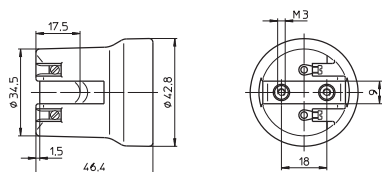

9

10